

Samsung A4 Multifunction

# SMART ProXpress

M4580FX

Samsung Desktop Multifunction printers with  
Smart User Interface powered by Android



THE NEW  
BUSINESS  
EXPERIENCE

SAMSUNG.  
PRINTING INNOVATION.



# GO BEYOND YOUR WORK CAPABILITIES WITH SMART PRINT INNOVATION

## Take business performance to a new level with smart printing

To keep up with the fast-paced business world, businesses today are embracing bring-your-own-device (BYOD) policies. This is leading to more efficient, seamless operations and highly productive, always-on employees using smart intuitive technology in the form of smartphones and cloud computing.

Businesses now want to extend that smart technology to all devices to gain the same level of intuitiveness and flexibility. A printer is no exception. From scanning to printing, printers are expected to have the same smart functionalities as cutting-edge mobile devices. Businesses seek smart printing solutions that can be easily managed while still delivering powerful performance at reduced costs.

Samsung's new A4 mono multifunction printer (MFP) *Smart ProXpress M4580 series* provides smart usability that allows users to work fast and efficiently using intuitive, easy-to-use controls. And with high-performance and resource-efficient features, these printers can meet the printing needs of small workgroups that depend on reliable, cost-competitive document-handling solutions while lowering total cost of ownership (TCO).

### Samsung Smart ProXpress:



M4580FX  
(45 ppm)



THE NEW  
BUSINESS  
EXPERIENCE

**SAMSUNG.**  
**PRINTING INNOVATION.**

# WORK SMARTER USING THE LATEST IN INTELLIGENT TOUCH FEATURES

## Experience smart printing, just like using a tablet

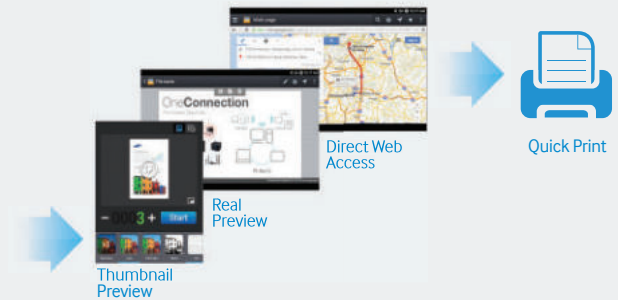

### Smart Use

#### Expand use with independent functions and extensibility

The interface also provides the Real Preview function from the preloaded applications, such as Copy, Send and Box. You can further extend usability with direct web access through the web browser to quickly print various web content, such as maps, pictures, emails and more without a PC.

Plus, you can access more useful features and solutions by downloading them through the Samsung printing app store.

### Smart Touch

#### Touch to print, just like on a tablet

The Smart ProXpress M4580 series provides innovative usability through Samsung Smart UX Center. Samsung Smart UX Center is based on the Android OS and designed to be more intuitive and scalable for all types of business environments.

This user-friendly UX provides intuitiveness, usability and extendability at the same time, ensuring optimal compatibility with various Android-based smart devices.

#### Enjoy preloaded applications and widgets

Printing applications are preloaded, including Copy, Scan/Send, Box, Job Status, Counter, Settings, Build Job, Address Book and Help, providing users with convenient usability. Plus, there are custom widgets for creating instant, one-tap access to frequently used functions.

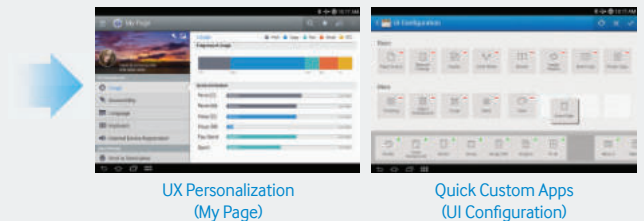

### Smart Manage

#### Personalize the UX through My Page

Enhance the UX by arranging and managing the environment by user with My Page. Simply customize the My Page settings and Quick Menu for each user and you can keep track of an individual's usage, control accessibility and more.

#### Create custom apps and UIs in a snap

Administrators can create quick custom apps directly on the devices. Instantly respond to different customers with one click by customizing the UI configuration quickly and easily.

**SAMSUNG**

# PROCESS PRINTS AND SCANS AT SUPER-FAST SPEEDS WITHOUT SACRIFICING QUALITY

## Boost productivity with fast performance

### Work fast, wait less

#### Scan at high rates

The Smart ProXpress M4580 series is equipped with dual-scan ADF technology, delivering ultra-high scanning speeds. These workhorse MFPs can scan up to 35 single-sided images per minute (ipm) and up to 60 double-sided ipm.

#### Faster print processing with zero fuss

The Smart ProXpress M4580 series prints at fast speeds of up to 45 pages per minute (ppm). A 1 GHz dual-core CPU provides the power and capacity to accomplish print and copy jobs of any size or complexity swiftly. Businesses can work smoothly and operate at an efficient level with high-performance speed printing.



Edge Enhancement



Negative Sharpening



De-ICE (Integrated Cavity Effect)



De-Screening

#### Get sharp-quality print output

Samsung's unique Rendering Engine for Clean Page (ReCP) technology delivers professional-quality output with sharp text and clean images, ensuring an excellent-looking printout every time. The innovative technology automatically sharpens the focus of both graphics and text. And with a superior resolution of 1,200 x 1,200 effective dpi, your scans, printouts, as well as your company will look professional.



THE NEW  
BUSINESS  
EXPERIENCE

SAMSUNG.  
PRINTING INNOVATION.



# MANAGE OPERATIONAL EXPENSES THROUGH COST-EFFICIENT ATTRIBUTES

## Lower your TCO with cost-efficient solutions and supplies

### Do more jobs, spend less

#### Save resources with low TCO printing

Businesses can handle heavy printing volumes while reducing labour costs with ProXpress M4580 Series' ultra-high-yield toner cartridges and drums. Flexible options range from toners that yield 40,000 standard black and white pages, while drums yield 100,000 standard black and white pages. These long-life consumables ensure businesses get the most out of their resources, resulting in lower TCO.

Toner Cartridge  
(40,000 pages)  
Drum  
(100,000 pages)



#### Create the printing environment that suits your needs with customized, cost-efficient solutions

Samsung's Business Core™ Printing Solutions (BCPS) work as efficiently as you do by providing cost-effective and safer print operation, increasing productivity and simplifying management. The solutions require no dedicated server and IT resources and reduce unnecessary printing and supply use, lowering TCO. These essential printing solutions include the following:

Business Core Printing Solutions	Benefits
<b>SecuThru™ Lite 2</b> <small>Business Core™ Printing Solutions</small>	Enhances document security and reduces costs with user authentication
<b>Secure Login Manager</b> <small>Business Core™ Printing Solutions</small>	Guards valuable data and devices from unauthorized use
<b>SmarThru™ Workflow Lite</b> <small>Business Core™ Printing Solutions</small>	Increases productivity with an automated workflow solution
<b>Cloud Connector</b> <small>Business Core™ Printing Solutions</small>	Scans to and prints from the cloud with easy, more secure access
<b>Usage Tracker</b> <small>Business Core™ Printing Solutions</small>	Controls printing expenses by easily tracking device usage per user



The Samsung Wireless & NFC printing option\* can be added to support various mobile printing solutions such as the following with just a tap:

- **User authentication:** Enable authorized users to tap and print to a Samsung MFP from their mobile devices.
- **More secure printing:** Authorize more protected release of documents held in the printer's memory with the BCPS and just a tap on your mobile device.
- **Easy wireless setup:** Configure wireless (IP) print setup from your mobile device without complicated activation steps with just a tap.
- **Device cloning:** Clone standardized functions of an MFP with just a tap on your mobile device.

\* The Wireless & NFC option will be available in Canada beginning in October 2014.



# CUSTOMIZE YOUR MFP WITH A FLEXIBLE PRINT SOLUTION

## Select from a range of options to create a tailor-made MFP Configurable devices for optimized performance

Businesses of varying sizes and industries can meet their specific needs with the Smart ProXpress M4580 series' unique configuration capabilities. Factory-provided modules serve as a basis upon which differing components are chosen along with a wide array of optional components, including but not limited to, a wireless and NFC option, an FDI kit and various stand sizes.

### Configurations & Options

#### DSDF (standard) Dual-Scan Automatic Document Feeder

- 50-sheet capacity
- Single-pass 2-sided document scanning

#### Wireless & NFC Option



- IEEE 802.11 b/g/n
- NFC (Active Type)



**2 GB  
Memory  
(DDR)**

#### Optional Paper Tray (Supports up to 3 ea)



#### Short Stand



# Samsung Multifunction SMART Pro Xpress M4580FX

## Technical details made to support your business

### General Specifications

Speed	45 ppm
Processor	1 GHz Dual Core
Memory	1 GB DDR3 Memory
Operational Panel Interface	10.1" Colour Touchscreen Panel
	Hi-Speed USB 2.0 Device (1EA), Host (2EA), Ethernet 10/100/1000 BaseTX, IEEE 802.11 b/g/n + NFC active (Optional)
Duty Cycle, Monthly	200,000 Images
Dimensions (W x D x H)	530 x 459.5 x 649 mm (20.9" x 18.1" x 25.5")
Weight	30.1 kg
Network Protocols	IP assign (Ethernet speed, DHCP), SWS, SNMP, SNTP, SetIP, SLP, DDNS, mDNS, WINS, LPD / LPR, SMB, FTP, SMTP, UPnP
OS Compatibility	- Windows: XP (32 / 64 bit) / Vista (32 / 64 bit) / 2003 Server (32 / 64 bit) / 2008 Server (32 / 64 bit) / Win7 (32 / 64 bit) / 2008 R2 (64 bit) / Win8 (32 bit / 64 bit) - Linux: RedHat Enterprise Linux WS 4 / 5 / 6 (32 / 64 bit) / Fedora 5 - 15 (32 / 64 bit) / openSUSE 10.2, 10.3, 11.0, 11.1, 11.2, 11.3, 11.4 (32 / 64 bit) / Mandriva 2007, 2008, 2009, 2009.1, 2010 (32 / 64 bit) / Ubuntu 6.06, 6.10, 7.04, 7.10, 8.04, 8.10, 9.04, 9.10, 10.04, 10.10, 11.04 (32 / 64 bit) / SUSE Linux Enterprise Desktop 10, 11 (32 / 64 bit) / Debian 4.0, 5.0, 6.0 (32 / 64 bit) - UNIX: Sun Solaris 9, 10, 11 (x86, SPARC) / HP-UX 11.0, 11i v1, 11i v2, 11i v3 (PA-RISC, Itanium) / IBM AIX 5.1, 5.2, 5.3, 5.4, 6.1, 7.1 (PowerPC) - Mac OS: X 10.5 - 10.9

### Paper Handling

Input Capacity & Types	Max 2,300 Sheets @ 75 g/m <sup>2</sup> (Std 520 + MP 100 + 3 x SCF 520 @ 80 g/m <sup>2</sup> )
Output Capacity & Types	520 Sheets @ 80 g/m <sup>2</sup> Face Down
Media Size	A4 / A5 / A6 / Letter / Legal / Oficio / Folio / JIS B5 / ISO B5 / Executive / Statement / PostCard 4x6 / Envelope B5 / Envelope Monarch / Envelope COM-10 / Envelope DL / Envelope C5 / Envelope C6 / Custom
Media Type	Plain Paper / Thin Paper / Bond / Punched / Pre-Printed / Recycled / Envelope / Label / CardStock / Letterhead / Thick / Coloured / Archive
Media Weight	Supported Weight: 60 - 163 g/m <sup>2</sup> (16 - 43 lb), Thin Paper (60 - 70 g/m <sup>2</sup> ) / Plain Paper (70 - 90 g/m <sup>2</sup> ) / Thick Paper (91 - 105 g/m <sup>2</sup> ) / Bond Paper (105 - 120 g/m <sup>2</sup> ) / Cardstock (121 - 163 g/m <sup>2</sup> )
ADF Document Size	Width: 105 - 216 mm (4.1" - 8.5") Length: 148 - 356 mm (5.8" - 14.0")
ADF Capacity	50 sheets @ 80 gsm

### Copy Specification

First Copy Out Time	6.5 sec
Resolution	Up to 1,200 x 1,200 dpi (1,200 x 600 x 2 bit)
Zoom Rate	25% - 400%
Multi-Copy	Up to 999
Duplex Copy	[Platen] - 1 → 1-Sided - 1 → 2-Sided (Book / Calendar) [DADF] - 1 → 1-Sided - 1 → 2-Sided (Output: Book / Calendar) - 2 → 1-Sided (Original: Book / Calendar) - 2 → 2-Sided (Original: Book / Calendar / Output: Book / Calendar)
Copy Features	N-Up (2 - 16) / ID Card Copy / Poster Copy / Clone Copy / Booklet / Covers / Transparencies / Book Copy / Save to File

### Print Specification

Resolution	- Up to 1,200 x 600 dpi (Optical) - Up to 1,200 x 1,200 dpi Effective Output (1,200 x 600 x 2 bit)
Emulation	PCL5e / PCL6 / PS3 / PDF V1.7
Fonts	- PCL: 111 Scalable Fonts / 1 Bitmap - PostScript 3: 136 Scalable Fonts
Duplex	Built-in
Utilities	Anyweb Print / Easy Printer Manager / Easy Colour Manager / Easy Document Creator / Net PC Fax / Direct Printing Utility / Easy Deployment Manager / Easy Eco Driver / Universal Printer Driver / Universal Scan Driver
Solutions	SyncThru Admin 6.0 / SmarThru Workflow Lite 1.0 / SecuThru Lite 2.0 / Secure Login Manager

### Scanner Specification

Speed	- Simplex: Up to 35 ipm (@ 300 dpi) - Duplex: Up to 60 ipm (@ 300 dpi)
Compatibility	TWAIN / WIA
Scan Size	- Platen / ADF: Max. 216 x 356 mm (8.5" x 14")
Scan File Formats	TIFF / JPEG / PDF / Compact PDF / XPS
Resolution	- Optical: 600 x 600 dpi - Enhanced: 4,800 x 4,800 dpi
Method	3ch Digital CIS Module
Scan to Destination	Scan to Email / FTP / SMB / HDD / USB / Client

### Options

#### SCF: Second Cassette Feeder (SL-SCF4500)

Input Capacity	520 Sheets @ 80 g/m <sup>2</sup>
Media Size	A4 / A5 / A6 / Letter / Legal / Oficio / Folio / JIS B5 / ISO B5 / Executive / Statement / PostCard 4x6 / Envelope B5 / Envelope Monarch / Envelope COM-10 / Envelope DL / Envelope C5 / Envelope C6 / Custom
Media Type	Plain Paper / Thin Paper / Bond / Punched / Pre-Printed / Recycled / Envelope / Label / CardStock / Letterhead / Thick / Coloured / Archive
Media Weight	Supported Weight: 60 - 163 g/m <sup>2</sup> (16 - 43 lb), Thin Paper (60 - 70 g/m <sup>2</sup> ) / Plain Paper (70 - 90 g/m <sup>2</sup> ) / Thick Paper (91 - 105 g/m <sup>2</sup> ) / Bond Paper (105 - 120 g/m <sup>2</sup> ) / CardStock (121 - 163 g/m <sup>2</sup> )
Dimensions (W x D x H)	433 x 459.3 x 145.8 mm (17" x 18.1" x 5.7")
Weight	9.8 kg

#### Short Stand (SL-DSK002S)

Dimensions (W x D x H)	480 x 553 x 120 mm (18.9" x 21.8" x 4.7")
Weight	13.3 kg

#### Memory (SL-MEM001)

Size	2 GB DDR3
------	-----------

#### Wireless + NFC (SL-NWE001X)

Wireless LAN	IEEE 802.11 b/g/n
NFC Type	Active Type

### Supplies

Extra High Yield Toner Cartridge (MLT-D303E)	Approx. 40,000 Pages
Imaging Unit (MLT-R304)	Approx. 100,000 Pages

# LEGAL AND ADDITIONAL INFORMATION

THE NEW  
BUSINESS  
EXPERIENCE

## SAMSUNG. PRINTING INNOVATION.

In modern society, keeping up with technology is critical to the success of any business or the productivity of any individual. The choice of technology can be the difference between survival and leadership.

As the workplace becomes more digitized and the workforce becomes more mobile, the printer and copier device must also adapt and evolve.

Printer technology and satisfaction lags the electronics innovation most employees expect. Nor has there been any major entrant to help shake change – until now.

Samsung is applying its ingenuity to develop breakthrough printing solutions that ignite productivity. Samsung has the electronics expertise to design and build a printer that fits the way society works today.

Printing for the modern world has arrived.  
**Samsung is printing innovation.**

For more information  
about Samsung Printing Solutions,  
visit [www.samsung.com/PrintingInnovation](http://www.samsung.com/PrintingInnovation)



## About Samsung Electronics

Samsung Electronics Co., Ltd. is a global leader in technology, opening new possibilities for people everywhere. Through relentless innovation and discovery, we are transforming the worlds of TVs, smartphones, tablets, PCs, cameras, home appliances, printers, LTE systems, medical devices, semiconductors and LED solutions. We employ 286,000 people across 80 countries with annual sales of US\$216.7 billion. To discover more, please visit [www.samsung.com](http://www.samsung.com).



## Real value. True performance.

Always make the right impression  
by using genuine Samsung supplies.

For more information  
about genuine Samsung supplies,  
visit [www.samsung.com/GenuineSupplies](http://www.samsung.com/GenuineSupplies)



Copyright © 2014 Samsung Electronics Canada Inc. All rights reserved. Samsung and MagicInfo are registered trademarks of Samsung Electronics Co. Ltd., used with permission. Specifications and designs are subject to change without notice. Non-metric weights and measurements are approximate. All data were deemed correct at time of creation. Samsung is not liable for errors or omissions. All brand, product, service names and logos are trademarks and/or registered trademarks of their respective owners and are hereby recognized and acknowledged.

Android is a trademark of Google Inc. The Android robot is reproduced or modified from work created and shared by Google and used according to terms described in the Creative Commons 3.0 Attribution License. IEEE is a registered trademark of the Institute of Electrical and Electronic Engineers, Inc.

<sup>1</sup> Mobile devices need to support NFC technology.

<sup>2</sup> There is also no app needed for iOS-supported devices using AirPrint.

Samsung Electronics Canada Inc.  
1-800-749-0205  
[www.samsung.com/business](http://www.samsung.com/business)

